

***Devireg™ 530, 531, and 532  
Installation Instructions***

# Contents

Applications and Functions.....	3
Maximum floor temperature setting .....	4
Light indications (LED) .....	5
Installation instructions .....	6
Placement of Devireg™ 530, 531, and 532 .....	7
Connection diagrams for Devireg™ 530, 531, and 532.....	8
Technical specifications for Devireg™ 530, 531, and 532.....	9
The DEVI™ Guarantee .....	10-11



The installation must only be carried out by an authorised electrician.

# 1. Applications and Functions

The Devireg™ 530 series is a line of electronic thermostats used for control of indoor heating.

The Devireg™ 530 is used for control of floor heating installations. The thermostat is equipped with a floor sensor for control of the desired floor temperature.

The Devireg™ 531 is used for control of room heating installations. The thermostat is equipped with a built-in air sensor for control of the desired room temperature.

The Devireg™ 532 is used for room heating installations. The thermostat is equipped with a built-in room sensor and floor sensor. The room sensor is used for control of the room temperature. The floor sensor is used for maximum temperature limitation in wooden floors and other heat sensitive floors. The range of operation can be limited:

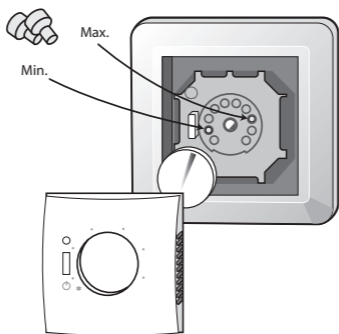

## 2. *Maximum floor temperature setting*

Maximum floor temperature is preset at the factory to 35°C for cable temperature safety.



Local building regulations must be observed when changing the maximum preset temperature.

You can/must set the maximum floor temperature on the Devireg™ 532 by taking off the front cover and with a screwdriver adjust the sunken temperature dial in the top left hand corner between 20° to 50°C.

### Notice:

The floor temperature is measured where the floor sensor is placed. The temperature of the bottom of a wooden floor can be up to 10 degrees higher than the top. Floor manufactures often specify the max. temperature on the surface of the floor.

Please contact your floor supplier for maximum surface temperature.

### 3. Light indications (LED)

The Devireg™ 530 series has a LED indicator above the 2 pole safety switch (see illustration).

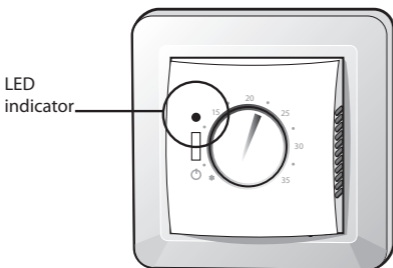

The LED has four indications:

- No light means the system is off.
- Red light means system is heating.
- Green light means system is standing by.
- Flashing green light means there is a problem with the floor sensor (only applicable for 530 and 532). Call your electrician.

Check connections, if they are OK, then disconnect the 2 sensor wires.

Measure the ohm value and check with the values in the table in Technical Specifications.

❄ is used for setting the thermostat in frost protection mode, i.e. keeping the room/floor temperature (depending on type of thermostat) at approx. 5°C at any time.

## 4. Installation instructions

When installing a thermostat from Devireg™ 530 series, you must first remove the front cover.

To remove the front cover, gently press the release tabs under the bottom of the thermostat with a screwdriver. Then remove the front.

You do **not** need to remove the set point dial.

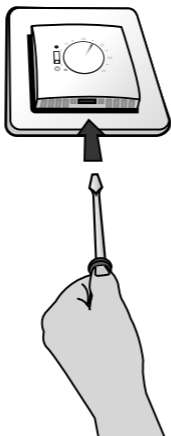

## 5. Placement of Devireg™ 530, 531, and 532

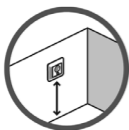

Installation height, typically between 80-150 cm for Devireg 531/532



In wet rooms it should be installed on an even surface, according to local building regulations.



At least 50 cm away from windows/doors that will be left open occasionally.

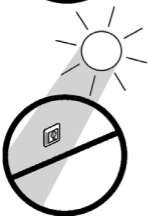

Not on a wall where it will be subjected to direct sunlight.



Not on the inner side of a wall facing the outside.

## Configuration - Max. floor temp.

Devireg™ 530  
Type D530

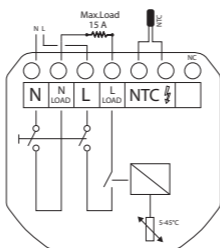

Devireg™ 531  
Type D531

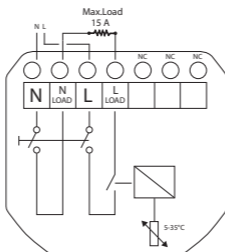

NC =  
no connection

Devireg™ 532  
Type D532

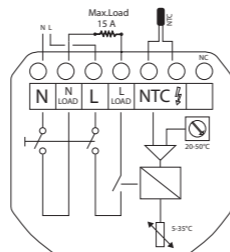

Temperature  
limiter  
NC =  
no connection



## 8. Technical specifications for Devireg™ 530, 531, and 532

Operation voltage	180-250 VAC, 50/60 Hz
Standby consumption	Max. 0.25W
Relays: • Resistive load • Inductive load	230V ~ 15A/3450W cos φ = 0.3 Max. 4A
Sensing unit	NTC 15 kOhm at 25°C
Sensing values: • 0°C • 20°C • 50°C	42 kOhm 18 kOhm 6 kOhm
Hysteresis	+/- 0.4°C for 530 (528) +/- 0,2 for 531 + 32
Ambient temperature	-10° to +30°C
Frost protection	5°C
Temperature range: • 530 • 531 • 532	5-45°C 5-35°C 5-35°C, floor temperature limiter range: 20-50° C
Sensor failure monitoring	The thermostat has a built-in monitoring circuit, which will switch off the heating if the sensor is disconnected or short-circuited.
IP class	31
Dimensions	85 mm x 85 mm

INT

## *The 2 Year DEVI Warranty:*

You have purchased a DEVI heating system which we are sure will serve to improve the comfort and economy of your application.

DEVI provides superior electrical heating solutions for total climate control in and around homes and buildings. DEVI offers a complete product program with Deviflex™ heating cables or Devimat™ heating mats, Devireg™ thermostats, Devifast™ fixing strips and Devi Self-limiting heating cables combined with additional products completing the product program.

This 2 year warranty applies to all DEVI products.

Should you, against all expectations, experience a problem with your DEVI product, you will find that DEVI offers a 2 year warranty from the date of purchase on the following conditions:

During the warranty period DEVI shall offer a new comparable product or repair the product in case the product is found to be faulty by reason of defective design, materials or workmanship. Repair or replacement shall be carried out at DEVI's discretion. DEVI shall not be liable for any consequential or incidental damages including, but not limited to, damages to property or extra utility expenses.

This warranty shall only be valid on production of proof of purchase and must be submitted to the installer or seller without undue delay.

An extension of the warranty period following repairs undertaken under warranty cannot be granted.

The DEVI Warranty shall not cover any damage caused by incorrect conditions of use, incorrect installation or if installation has been carried out by non-authorized electricians. All work will be invoiced in full if DEVI is required to inspect or repair faults that have arisen as a result of any of the above. The DEVI Warranty shall not extend to equipment which has not been paid in full.

DEVI will, at all times, provide a rapid and effective response to all complaints and inquiries from our customers.

The warranty explicitly excludes all claims exceeding the above conditions.

# 2 YEAR WARRANTY

## Warranty Certificate

The DEVI™ Guarantee is granted to:

Name:

---

Address:

---

City:

Country:

---

Telephone:

---

### Attention:

The Warranty Certificate must be completed correctly for the  
Warranty to be valid.

Please read the Warranty conditions on the previous page.

Type of thermostat:

Material number:

---

Electrical installation by:

Date:

---

Suppliers Stamp

Date / -



Article No.: 08095821

Version - 02.05



**DEVI A/S**

Ulvehavevej 61

DK-7100 Vejle

Tel: +45 74 88 85 00

Fax: +45 74 88 85 01

[www.devi.com](http://www.devi.com)